

## 1000 - 1500 SERIES

<b>Part Numbers Affected:</b>	<b>618-05010, 918-05010, 618-05100, 918-05100.</b>
<b>Models Affected:</b>	<b>13xx93xxxxx (LTX and LGT Models).</b> (Models that begin with <b>13</b> and have <b>93</b> in the 5th and 6th position).
<b>Serial Number Range Affected:</b>	Model Year 2013 and 2014 (1A033H3xxxx through 1F054H3xxxx).
<b>Date:</b>	July 17, 2014/September 15, 2015 <b>Revised June 22, 2016 (Destroy All Previous Copies).</b>
<b>Subject:</b>	<b><u>Tuff Torq K46 Hydrostatic Transmission Axle Seal Oil Leak</u></b>

**NOTE:** These materials are prepared for use by trained technicians who are experienced in the service and repair of equipment of the kind described in this publication, and are not intended for use by untrained or inexperienced individuals. Such individuals should seek the assistance of an authorized service technician or dealer.

**NOTE:** Always wear eye protection while servicing equipment. Wear hearing protection when appropriate. Always work in a well ventilated area and follow all safety precautions when dealing with combustible materials.

**NOTE:** Left (LH) and Right (RH) sides are determined from the operator's position and facing in the forward direction.

### PURPOSE:

It has come to our attention that certain axle seals on the above listed models have the potential to leak oil. A Service Kit (including instructions) has been developed to replace both axle oil seals on all tractors exhibiting this leaking condition within the Serial Number Range Affected.

### ACTION REQUIRED:

1. If you have any non-retailed inventory of Models Affected within the Serial Number Range Affected, then proceed to Step 7 and follow the procedure for **753-08294A** Seal Kit replacement.
2. If a Model Affected tractor within the Serial Number Range Affected is presented for service and exhibits an oil leak at an axle seal, then proceed to Step 3.
3. Check the transmission oil level and fill as needed with SAE 10W-30 Class CD oil.

**NOTE:** Oil level should be to the height of the internal ledge feature located below the magnet shown in Figure 1.

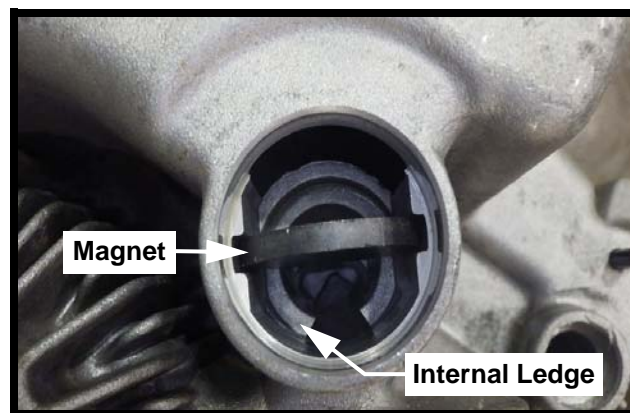

**FIGURE 1**

4. Start the tractor and allow to reach operating temperature. Position the front tires against the side of a building or another solid immovable structure. Driving the tractor up a hill or incline is also an appropriate test procedure. Depress and release the forward hydro control pedal several times. If the transmission growls or is not able to turn the rear tires over, then it does not pass the test.

5. If the transmission passes the test, proceed to Step 7 and follow the procedure for a **753-08294A** Seal Kit replacement. **NOTE: Do Not install the 753-08294A Seal Kit replacement in a transmission that does not pass the test described in Step 4.**

6. If the transmission does not pass the test, then proceed no further under this Service Advisory and follow the procedure for a transmission replacement under Service Advisory **CC-915** for all **618-05010, 918-05010** transmissions or Service Advisory **CC-916** for the **618-05100, 918-05100** transmissions. Reimbursement for work performed to diagnose a tractor requiring a transmission replacement under this Service Advisory will be covered under the applicable **CC-915** and **CC-916** Service Advisory.

7. From your parts source, order Service Kit **753-08294A**. Figure 2 below shows contents of Service Kit.

### Service Kit Contents

(See Figure 1)

ITEM NO.	PART NUMBER	QTY	DESCRIPTION
1	TT-168T2036300	1	SEALING CAP 30
2	TT-187T0134280*	2	SEAL 19 x 32 x 8
3	710-05339A	2	HHCS-5/16-24 x 0.750" SEMS PATCH
	**	1	THIS INSTRUCTION SHEET

\* New Part Number

\*\* Not Available Separately

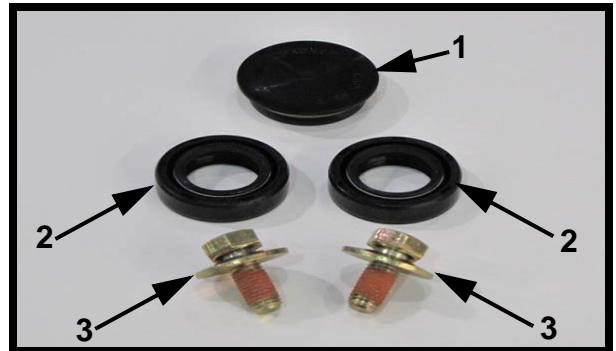

**FIGURE 2**

8. Install Service Kit **753-08294A**. Follow all instructions provided with the Service Kit.

9. Use a permanent marker to place a hand written "SR" on the Model / Serial Number label as shown in Figure 3, then proceed to Step 10.



**FIGURE 3**

10. Submit a warranty claim (one tractor per claim).

11. To claim the Tuff Torq Administration Fee (TTAF), add the following under "Miscellaneous Parts". Type in as shown below:

**Part No:** TTAF **Description:** Labor **Price USD:** \$10.00 **Qty:** 1

**NOTE: Be Sure To Include On The Warranty Claim, All Model and Serial Numbers For Both Tractor and Transmission Along With Hours Used.**

**ATTENTION: Warranty coverage according to this Service Advisory is approved under the applicable Cub Cadet Warranty (3 years or 120 hours). As part of a Tuff Torq Field Service Support Initiative, Models Affected within the Serial Number Range Affected are eligible for coverage for up to 5 years or 200 hours.**

Warranty: Normal warranty terms apply. Indicate Service Advisory **CC-839B** and **TT-19216334280** as the original failed part on the claim. Repair time allowance up to **1.0** Hrs.

**Mandatory>>>**When completing the warranty claim, select the drop down text shown below for the following claim fields:

**GROUP CODE:** Drive system to wheel or track

**FAIL CODE:** Leaking

**WORK PERFORMED:** Hydrostatic Drive

SERVICE MANAGER	PARTS MANAGER	SALES MANAGER	SERVICE TECH.	SERVICE TECH.

Circulate and Initial