

Hand Held Equipment / String Trimmers

Troy-Bilt Models Affected: TB625EC (41ADZ62C766).
TB675EC (41ADZ67C766).

Serial Number Range Affected: 2013 Production Models That Incorporate The AC8 Engine.

Date: June 27, 2013

Subject: 753-08159 Pawl Kit

NOTE: These materials are prepared for use by trained technicians who are experienced in the service and repair of equipment of the kind described in this publication, and are not intended for use by untrained or inexperienced individuals. Such individuals should seek the assistance of an authorized service technician or dealer.

NOTE: Always wear eye protection while servicing equipment. Wear hearing protection when appropriate. Always work in a well ventilated area and follow all safety precautions when dealing with combustible materials.

NOTE: Left (LH) and Right (RH) sides are determined from the operator's position and facing in the forward direction.

ACTION REQUIRED: This advisory is for **INFORMATIONAL PURPOSES ONLY**

PURPOSE:

We have developed a Service Kit **753-08159**, to allow the Starter Pawls, Return Springs and E-Clips to be available as service parts. If the return springs on the starter pawls fail, order a **753-08159** Pawl Kit.

NOTE: Always replace both starter pawls and springs, even if only one side has failed.

753-08159 Service Kit Contents

ITEM NO.	PART NUMBER	QTY	DESCRIPTION
1	Not Available	2	PAWL
2	Not Available	2	PAWL RETURN SPRING
3	Not Available	2	E-CLIP

Instruction sheet included with kit.

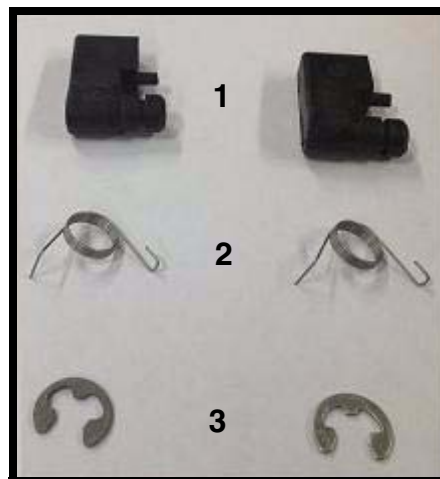

FIGURE 1

NOTE: Please Make Note Of The Part Number (753-08159 Pawl Kit) In Any Parts Reference Material Utilized For Ordering Parts.

SERVICE MANAGER	PARTS MANAGER	SALES MANAGER	SERVICE TECH.	SERVICE TECH.

Circulate and Initial