



Service Advisory

MTD-146

Lawn and Garden Tractors

Models Affected: **Troy-Bilt:** **TB2450** (13AA92KP066, 13WQ92KP066)
 TB2142 (13AL91KS066)
 TB2246 (13AT91KT066, 13WX91KT066)
 TB2654 (14AK94KK066, 14AR94KK066)

MTD Gold: 13AP925P004, 13AX915T004, 14AK945K004

MTD Yardman: 13AX915T001

Serial Number Range Affected: 2009 Through 2013 Production

Date: June 1, 2013

Subject: **Failure of Drive System Idler Spring Anchor Point**

NOTE: *These materials are prepared for use by trained technicians who are experienced in the service and repair of equipment of the kind described in this publication, and are not intended for use by untrained or inexperienced individuals. Such individuals should seek the assistance of an authorized service technician or dealer.*

NOTE: *Always wear eye protection while servicing equipment. Wear hearing protection when appropriate. Always work in a well ventilated area and follow all safety precautions when dealing with combustible materials.*

NOTE: *Left (LH) and Right (RH) sides are determined from the operator's position and facing in the forward direction.*

PURPOSE: When the bolt that serves as the anchor point for the drive system idler spring fails, order and install Service Kit 753-08109.

SYMPTOM(S): Loss of drive or drive belt slips.

CORRECTIVE ACTION: See Page 2, Figure 1.

THIS AREA INTENTIONALLY LEFT BLANK

ITEM NO.	PART NUMBER	QTY	DESCRIPTION
1	712-04064	1	1/4 x 20: Nylon Flange Locknut
2	738-04282	1	Shoulder Bolt: .32 x 1.8: 1/4 x 20
3	*	1	THIS INSTRUCTION SHEET

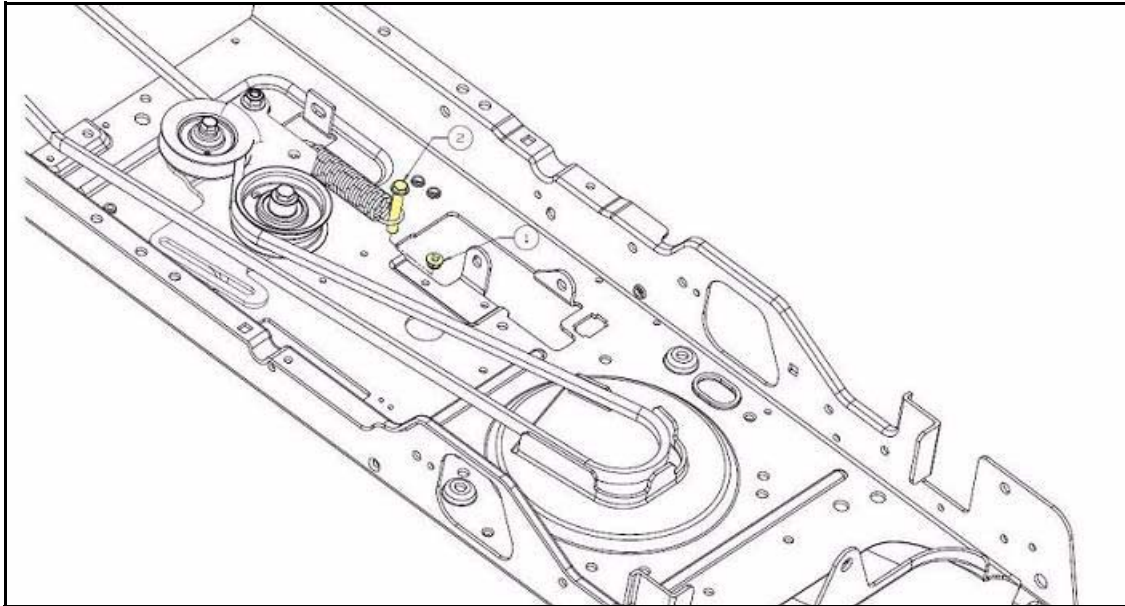

1. Broken screw to be drilled out to a .290" / .260" hole (9/32"). Drill and replace with shoulder bolt and flange locknut.

NOTE: Lock out parking brake first and unhook belt, then the spring will be easy to disconnect and install.

Figure 1

ACTION REQUIRED: This is to be considered a **Fix-As-Fail** repair.

Warranty: Normal warranty terms apply. Indicate Service Advisory **MTD-146** and **P/N 710-1325** as the original failed part on the claim. Repair time allowance is **0.3 Hrs.** List model and serial number of the unit on the claim.

Mandatory>>>When completing the warranty claim, select the drop down text shown below for the following claim fields:

GROUP CODE: Drive System To Wheel Or Track

FAIL CODE: Slipping

WORK PERFORMED: Idler Drive

SERVICE MANAGER	PARTS MANAGER	SALES MANAGER	SERVICE TECH.	SERVICE TECH.

Circulate and Initial