



Service Advisory

MTD-213

2 and 3 Stage Snow Throwers

Affected Models: All MTD Branded 2 and 3 Stage Snow Thrower Models That Begin with 31 and have a 5, 6, 7, or 8 in the 5th Character position:
31xx5xxxxxx, 31xx6xxxxxx, 31xx7xxxxxx, 31xx8xxxxxx

Affected Part Number: **790-00689A**

Affected S/N Range: **June 1, 2016 thru October 1, 2016 (xF016xxxxxx-xJ016xxxxxx)**

Date: September 27, 2016

Subject: A few of the 2016 Production 2 and 3 Stage Snow Throwers had a running change made to the belt keepers to correct an interference issue.

NOTE: These materials are prepared for use by trained technicians who are experienced in the service and repair of equipment of the kind described in this publication, and are not intended for use by untrained or inexperienced individuals. Such individuals should seek the assistance of an authorized service technician or dealer.

NOTE: Always wear eye protection while servicing equipment. Wear hearing protection when appropriate. Always work in a well ventilated area and follow all safety precautions when dealing with combustible materials.

NOTE: Left (LH) and Right (RH) sides are determined from the operator's position and facing in the forward direction

Purpose: Some 2016 built 2 and 3 Stage snow throwers have been found to have a slight interference between the engine pulley and the stamped steel belt keeper inside of the belt cover. This interference may be noticed by a metallic rubbing sound and a visual inspection of the belt keeper. See Figure 1.

Corrective Action: Order a new belt keeper, part number **790-00689A**, and install it into the cover using the two self-tapping screws. Be careful not to overtighten the screws and strip out the plastic. Torque them to between 8 and 13 in.lbs. See Figure 2. Reinstall the belt cover, start the unit and listen for the metallic rubbing sound. This new belt keeper should correct the interference problem.

This Advisory is Considered to be Fix-As-Fail Only



Figure 1

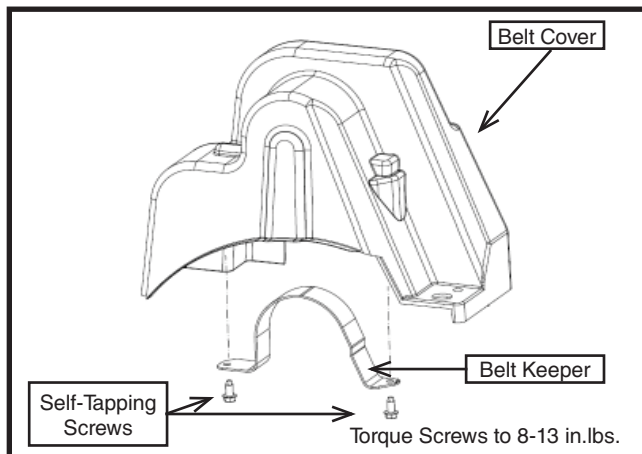

Figure 2

Warranty: Normal warranty terms apply. Indicate Service Advisory **MTD-213** and **790-00689A** as the original failed part on the claim. Repair time allowance is **0.3** hours.

Mandatory>>>>When completing the warranty claim, select the drop down text shown below for the following claim fields:

Group Code: Drive System to Wheel or Track

Fail Code: Rubbing

Work Performed: Auger Belt Pulley

| SERVICE MANAGER | PARTS MANAGER | SALES MANAGER | SERVICE TECH. | SERVICE TECH. |
|-----------------|---------------|---------------|---------------|---------------|
| | | | | |